

母座 (Socket)

下图为母座内部结构

(The following figure shows the internal structure of the socket)

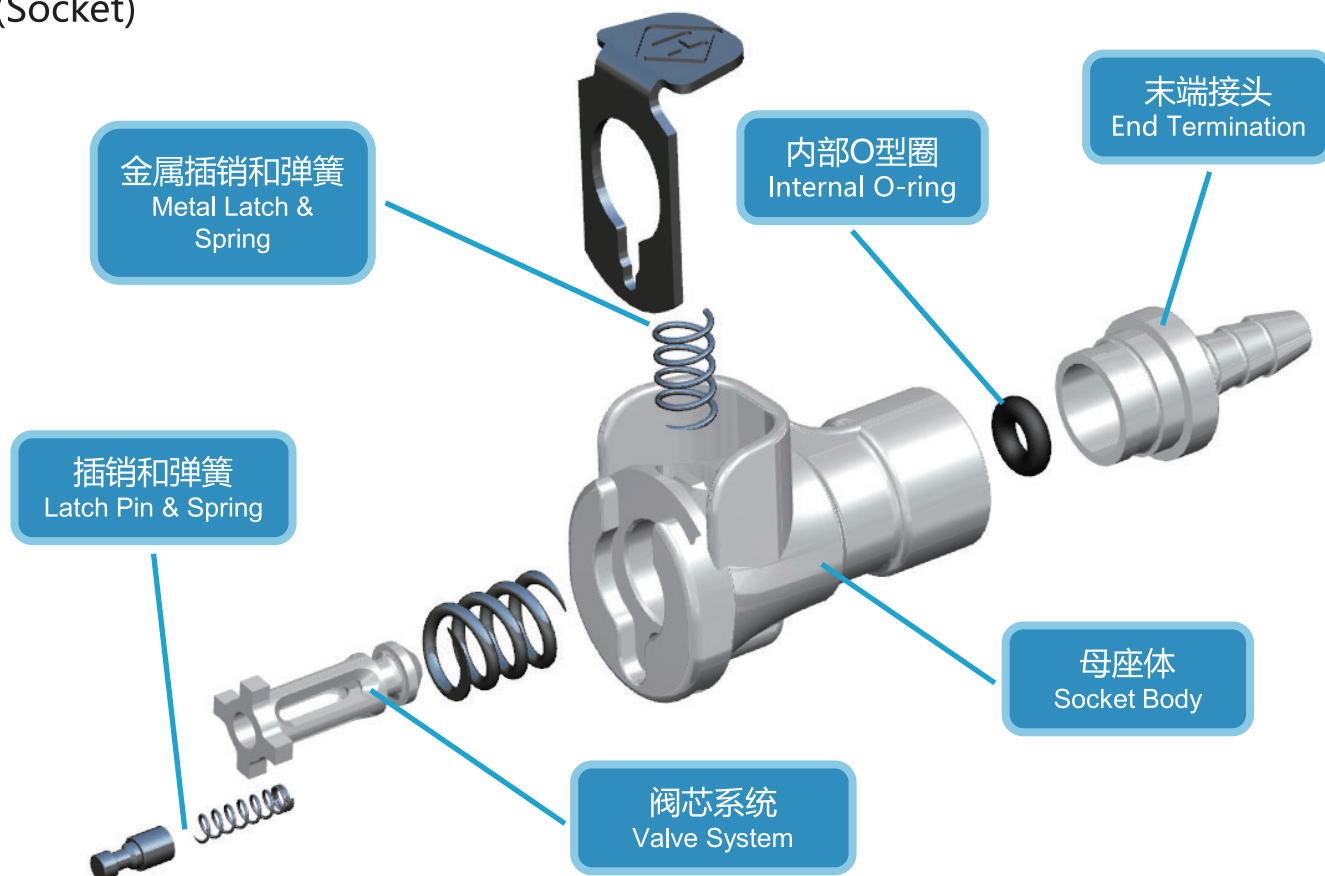

微型扭锁技术

Micro Twist Lock Technology

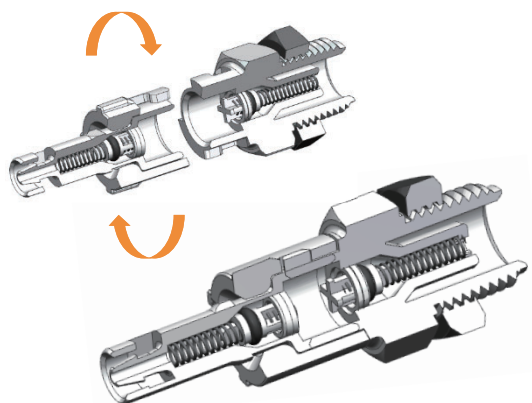

金属插销技术

Metal Bolt Technology

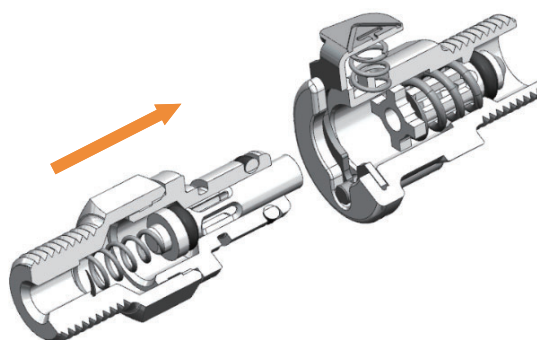



公 插 (Plug)

下图为公插内部结构

(The following figure shows the internal structure of the plug)

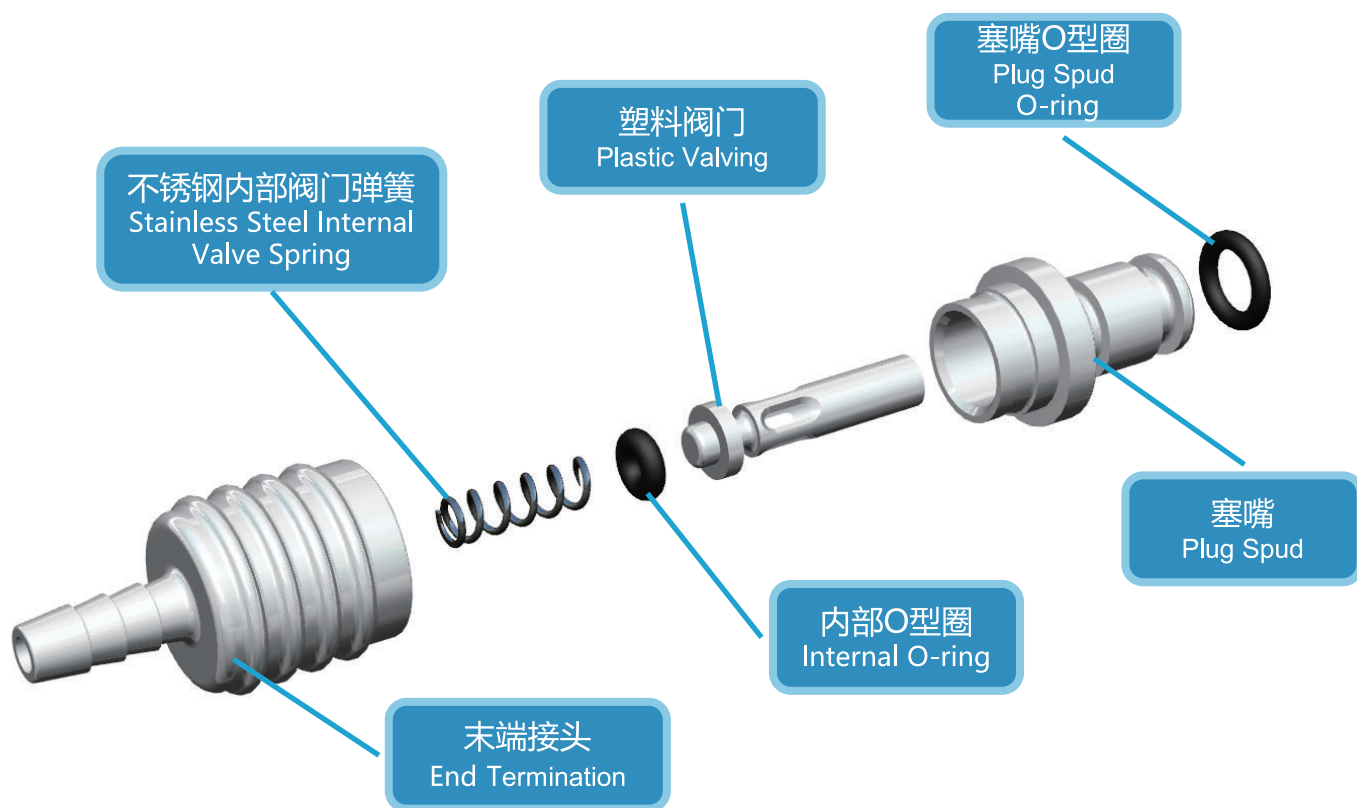

塑料锁扣技术

Plastic latch technology

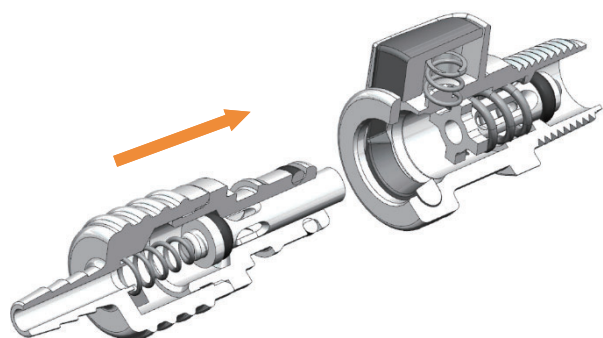

多端口技术

Multiport technology

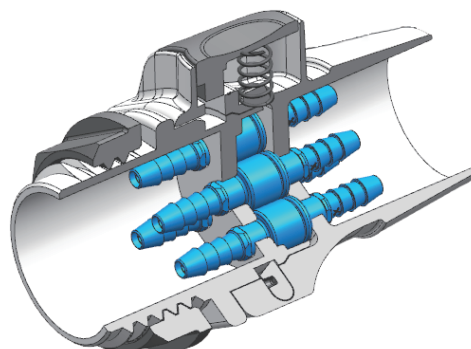

产品特色

Product features

流量大小 (Flow size)

1/16 流量 (Flow)



1/8 流量 (Flow)



1/8 流量 (Flow)



1/4 流量 (Flow)



1/4 流量 (Flow)



3/8 流量 (Flow)



材料及颜色 (Material and color)

聚甲醛(POM)

Acetel(POM)

颜色(Colors)  

聚丙烯(PP)

Polypropylene (PP)

颜色(Colors)   

黄铜(CU)

Chrome Brass(CU)

颜色(Colors) 

不锈钢(SUS)

Stainless Steel (SUS)

颜色(Colors) 

医疗级(ABS)

Medical Grade (ABS)

颜色(Colors) 

医疗级(PC)

Medical Grade (PC)

颜色(Colors) 

实物及样色



应用及优势 (Application and advantages):

本公司产品同系列可交叉使用，增加应用场合的多样性用途如下：

The same series of our products can be used interchangeably to increase the diversity of applications, as follows:

- 喷墨打印 (Inkjet printing)
- 防寒服 (Winter clothes)
- 照片开发 (Photo development)
- 血压袖带 (Blood pressure cuff)
- 气相色谱法 (Gas chromatography)
- 粒子计数器 (Particle counter)

内部截止阀 (Internal Shut-off Valves)

内部有无阀体均可交叉使用如下：

Both internal and external valve bodies can be used interchangeably as follows

无阀公插和无阀母座

Non-Valved Plug & Socket

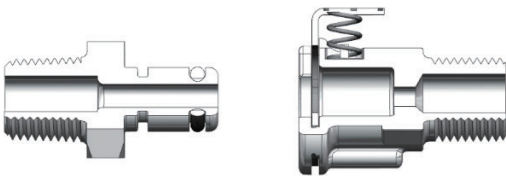

有阀公插和无阀母座

Valved Plug & Non-Valved Socket

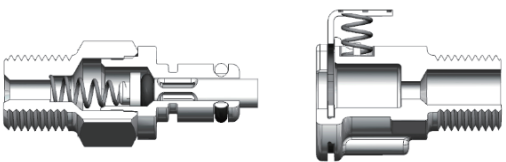

无阀公插和有阀母座

Non-Valved Plug & Valved Socket

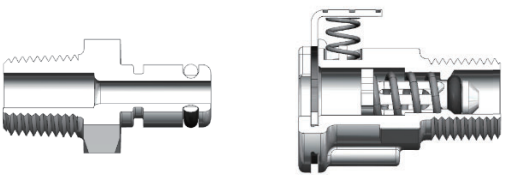

有阀公插和有阀母座

Valved Plug & Socket

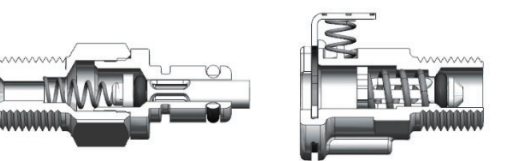

终端连接方式 (End Terminations)

本公司产品能以多种对接形式连接管道

Our products can connect pipes in various docking forms

管螺纹式 (Pipe Threads) :

可提供外螺纹或内螺纹锥形和直螺纹 NPT、BSPP、BSPT 和 SAE，请联系我们了解非标准螺纹要求。

Available in male or female tapered and straight, NPT, BSPP, BSPT and SAE. please contact us for non-standard thread requirements.

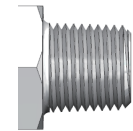

倒钩式 (Hose Barb) :

用于低硬度管道，如PVC、聚氨酯、硅树脂、橡胶等。

For use with lower durometer tubing such as PVC, Polyurethane, Silicone, rubber, etc.



快拧式 (Ferruleless Polytube Fitting) :

用于半刚性管道，如聚乙烯等尼龙、聚氨酯、聚丙烯等。

For use with semi-rigid tubing such as polyethylene, nylon, polyurethane, polypropylene, etc.

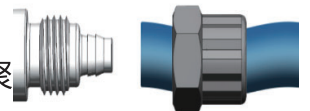

快插式 (Push In) :

用于半刚性管道，如聚乙烯等尼龙、聚氨酯、聚丙烯等。只需要将管道推入即可进行连接，不需要螺母压缩。

For use with semi-rigid tubing such as polyethylene, nylon, polyurethane, polypropylene, etc. Simply push tube in for connection. No compression nut required.

